

display werks

quality and innovation in LCD integration

4050 Series LCD Touch Screen Monitor

Large Format Interactive LCD

Display Werks Part #4050-TU-FWD40LX2F-2S, Based on the Sony FWD-40LX2F

- 40" LCD Touch Screen
- Integrated rugged SAW (Surface Acoustic Wave) Touch Screen
- Low Power Consumption
- Supports multiple video inputs
- 1366 x 768 High Resolution
- USA Service and Technical Support
- Touch Screen Integrated within Factory Enclosure
- 1 Year Warranty / 3 Year Warranty (Monitor)
- 3 Year Warranty (Touch Sensor and Controller)

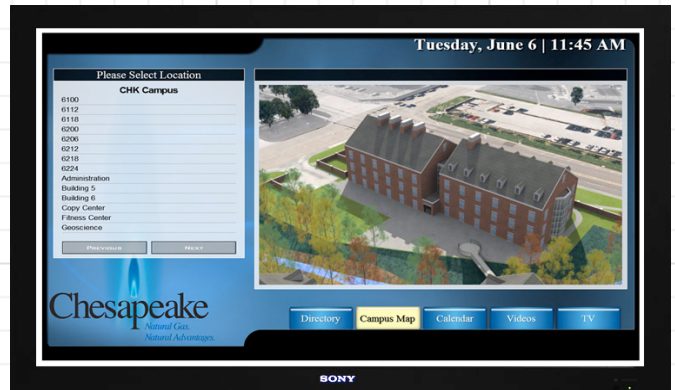

Base on the Sony LCD Monitor Model: FWD-40LX2F

- LCD Element:** 40" diagonal LCD
Max. Resolution: (pixels) 1366 x 768
Pixel Pitch: 648 x 648 mm
Max. Colors: 16.77 Million colors (8 bits/color)
Display Response Time: 8 ms
Viewing Angle: 178° right/left/up/down
Screen active area: inch (mm) 34-27/32 x 19-19/32 (885.2 x 497.7)
Contrast Ratio: 1300:1
Brightness: 500 cd/m2 (before touch screen)
Power Requirements: AC 100V—240 V, 50/60 Hz
Operating Temperature: 0° F to 35° C
Operating Humidity: 20% to 90% (no condensation)
Power Consumption: 220W in operation
Speakers: Optional
Dimensions: Approx. 38.90 x 23.26 x 5.16 (988 x 591 x 131) with Touch Screen Installed.
Weight lbs.: (kg) Approx. 69.6 lbs (31.5) with integrated Touch Screen installed.

SONY

Display Werks is a SONY Authorized Integrator

MicroTouch™

3M

Display Werks is an Authorized 3M™ DST System Integrator

3M and MicroTouch are trademarks of the 3M Company

Input Terminals		Output Terminals	
HDMI™ Connections: 2 HDMI	2 x HDMI ver 1.1	Analog Audio	Speakers (L/R) Optional
HD Component Video Input	RGB/Component in: D-sub 15 Pin female	Control S	1 (side)
Video In (BNC)	1 (when Video is used, S-video is inactive)	S-Video Out	Mini Din 4pin (x1) Loop through
Serial (RS-232)	D-sub 9 Pin x 1	Composite Video	BNC (x1) Loop through
Control S-Input	1 (Side)	<p>Quality and Innovation in LCD Integration.™</p>	
PC Audio	Shared Between 2x HDMI and HD-15		
S-Video	Mini Din 4-pin (x1) (when S-video is used, Composite video is inactive)		
Analog Audio	Pinjack x2		

display werks

Sony 4050 FWD-40LX2F Rev 3 SAW

display werks

quality and innovation in LCD integration

4050 Series LCD Touch Screen Monitor

Large Format Interactive LCD

Display Werks Part #4050-TU-FWD40LX2F-2S, Based on the Sony FWD-40LX2F

4050 Sony Dimensional Drawing

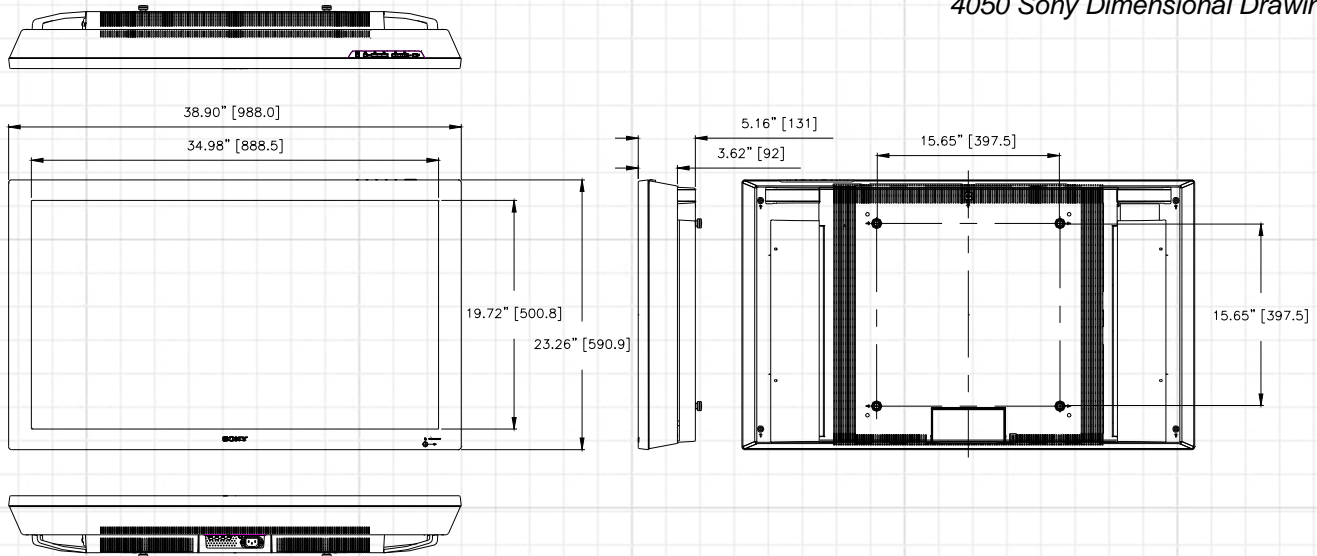

Surface Acoustic Touch Screen Specifications:

- **Total additional weight to monitor:** 14.5 lbs.
- **Construction:** Glass panel with transducers attached to the front surface of the glass substrate.
- **Positional Accuracy:** Standard deviation of error is less than 0.080 in (2.03 mm) Equates to less than 1% error on most displays.
- **Light Transmission:** Up to 92%.
- **Operating Temperature:** -20°C to 50°C
- **Touch Active Force:** Less than 3 ounces
- **Operational Altitude:** 10,000 ft Above Sea Level
- **Expected Life Performance:** No known wear-out mechanism, as there are no layers, coating, or moving parts. This SAW technology has been operationally tested to more than 50 million touches in one location without failure, using a stylus similar to a finger.
- **Total Additional Depth to Sony FWD-40LX2F:** 1/4"

Touch screen Connector Specifications:

- **Interface:** USB 2.0
- **Maximum Single USB Cable Length:** 5m (16.4 ft)

Note: When using USB over distances of 5m, a USB extension system can be used.

Note: Power for the LCD monitor itself requires a connection to a 110 VAC receptacle. In addition the Sony 4050 series SAW touch screen monitors require an external power supply to drive the integrated touch screen controller. This small form factor 110 VAC to 5Vdc power supply is included with every Sony 4050 series SAW touch screen monitor.